



Modular cold rooms
iso range • minibox • coldbox

isomasters



CONTENTS

About isomasters	3
Our service & guarantee	3
ISO-range	4
ISOSTOCK	15
MINIBOX	16
COLDBOX	18

The complete range from isomasters comprises of clean rooms, modular cold rooms, as well as a large range of doors and accessories for every application.



ABOUT ISOMASTERS

isomasters is the new dynamic company that brings the two internationally renowned manufacturers Isocab-Isobar together under one new brand name.

Since November 2016, both production companies of modular ISO panels and insulated doors, have merged into a joint venture under the umbrella of the Kingspan Group.

Since then, the product range has been significantly expanded and renewed, and in order to support this dynamic and new vision, the two names were grouped into the new brand **isomasters**.

The company manufactures modular cold rooms and freezers for the food and retail sectors, including meat, fish, dairy and vegetable processing companies, restaurants, supermarkets, logistical centres and the pharmaceutical sector. With an annual turnover of more than EUR 50 million and a modern production facility in Belgium, **isomasters** is one of the main suppliers of construction systems for conditioned industrial environments.

The complete **isomasters** range consists

of modular cold rooms and freezers, called MODULAR, MINIBOX and COLDBOX, and a very extensive and innovative series of insulated doors and accessories for any application.

Technical service

isomasters strives to provide its customers with the best service. This means high levels of customer support and technical expertise from the design phase through to product training and after-sales support.

Our Technical Services team forms an important part of this support. The team provides information on the technical aspects of construction when using **isomasters** products.

Service and guarantee

Since its creation, and to this day, **isomasters** is dedicated to serving its customers with products that satisfy the highest level of specifications, and which achieve all major international industry certification standards.

isomasters has built its success on precise and timely response to customer needs, thanks to its dedicated and qualified personnel.

isomasters delivers full turn-key service, from the design stage through to after-sales care, in its core European markets, as well as in many export destinations around the world.

CE Applicable for range of doors

ISO-RANGE

Advantages of the ISO range

- Flexible modular cold room solution which is easy to take apart
- Quick installation
- Easy to clean
- Practical and efficient temperature control for temperature controlled environments
- Large choice of models and accessories
- Assembly plan is delivered with each order
- Installation possible from the inside or outside (on request)
- A tongue and groove jointing method ensuring a secure airtight and watertight joint

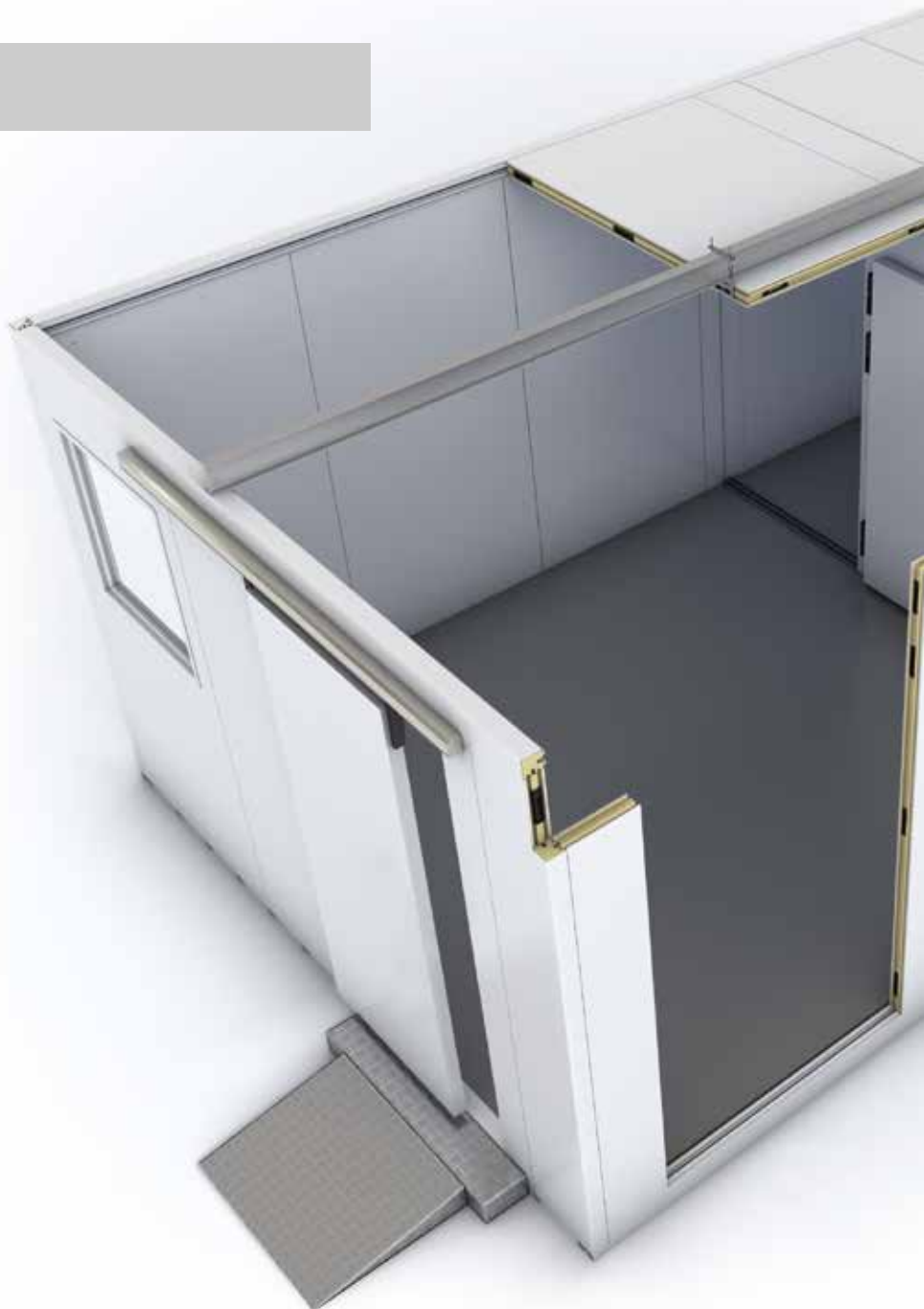

Applications



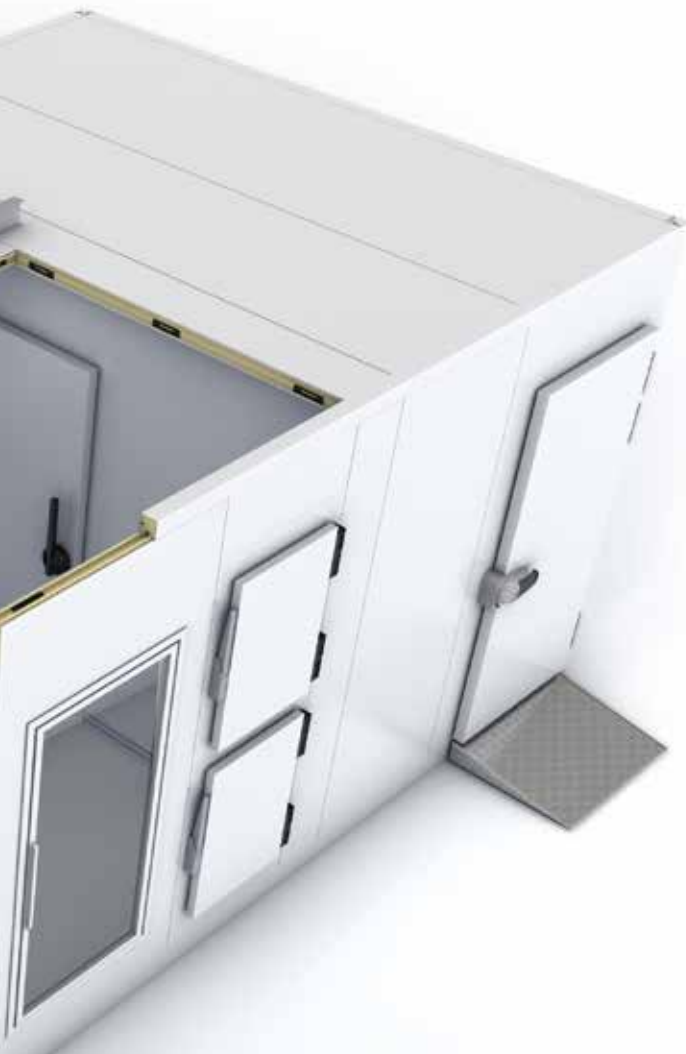

Product applications

The ISO Range is the perfect solution for constructions requiring positive or negative temperatures, and freezers. They are ideal for supermarkets, the retail and catering sector, hotels, and pharmaceutical and industrial constructions.

Application	Recommended panel system
Cold rooms for the preparation and transformation of food	ISO 60/80/100/140/180
Storage facilities for medication and laboratory testing	ISO 60/80/100/140/180
Cold store facility for stocking dairy produce, cooked foods and ready-made meals	ISO 80/100
Freezer rooms for stocking of frozen goods	ISO 100/140/180

COATING SELECTOR

CLEANsafe 25 µ	Standard: RAL 9010
CLEANsafe 55 µ	Standard: RAL 9010
CLEANsafe 304	AISI 304 - sun brushed AISI 304 - natural 2B AISI 304 - line brushed 4N AISI 304 - design linen
CLEANsafe 316	AISI 316 - sun brushed

See the 'Coating Selector & Maintenance Guide' on www.isomasters.com





ISO-RANGE

Installation

The ISO Range is quick and easy to assemble and install. All the packs are marked with descriptions of the product, are individually packed and contain complete installation information.

The surface on which the floor panels will be installed should be level and smooth. The panels are assembled with the aid of the unique locking system installed during the injection of the foam. The panels can be locked in place with the hexagon shaped M12 key.

The doors for the ISO Range are delivered with their own insulated doorframe. The system can be easily taken apart, which allows for a large flexibility in the event of an extension being needed.

Please note that the electrical work, for example ventilation port and heating cables should be installed by qualified personnel.



Junctions

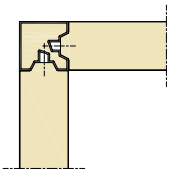

ISO 06
Internal wall/Internal wall -
Ceiling

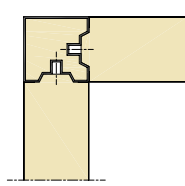

ISO 08 - 10 - 14 - 18
Internal wall/Internal wall -
Ceiling

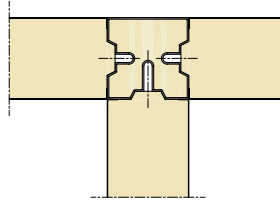

ISO 08 - 10 - 14 - 18
Internal wall/Internal wall -
Ceiling



T-panel
300 mm

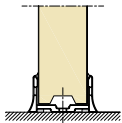

ISO 06
Without floor

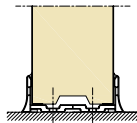

ISO 08 - 10
Without floor

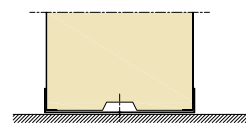

ISO 14 - 18
Without floor

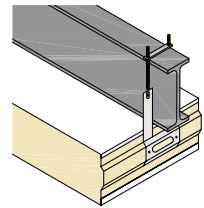

Ceiling suspension



ISO 06
Angle - 2T



ISO 08 - 10 - 14 - 18
Angle - 2T

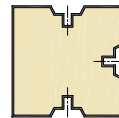

ISO 08 - 10 - 14 - 18
Angle - 3T

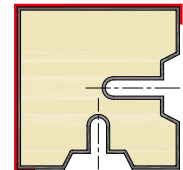

Angle - 2T - covered

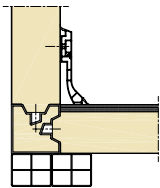

*** ISO 06**
With floor

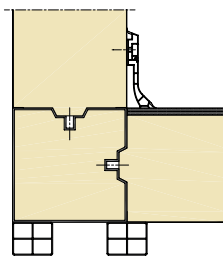

*** ISO 08 - 10 - 14 - 18**
With floor

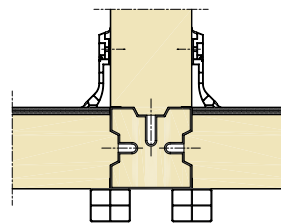

*** ISO 08 - 10 - 14 - 18**
With floor

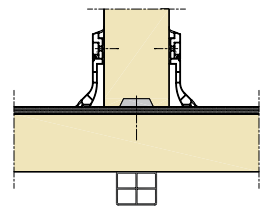

*** ISO 06 - 08 - 10**
With floor+ partition wall



ISO 06
U-profile for installation



ISO 08 - 10
U-profile for installation



Rafter
Dimensions
40 x 50 mm / 400 mm

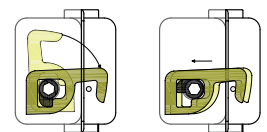

Panel-lock

* Plinths are optional



ISO-RANGE

Product description

The ISO Range is a modular cold room solution created for coldstore facilities, and adapted to sectors requiring the stockage of perishable goods.

The ISO Range of insulated sandwich panels is composed of two smooth metal sheets, injected with polyurethane foam. The insulated sandwich panels are resistant to humidity, mould and bacteria, and are suited for internal wall or ceiling installations. Once installed following the **isomasters** specifications, the system allows for maintaining controlled environments, thanks to strict tolerances and a precise insulated panel manufacturing process.

All **isomasters** systems are designed for and adapted to the space available to the customer.

Technical specifications

Construction	Insulated PUR foam core panels with modular dimensions
Width of the module	300 mm
Thickness of the panels	ISO 06 = 60 mm - ISO 08 = 80 mm - ISO 100 = 100 mm ISO 140 = 140 mm - ISO 180 = 180 mm
Width of the panel	300 mm - 600 mm - 900 mm - 1,200 mm (± 1.0 mm)
Length of the panel	From 300 mm to 3,900 mm (± 1.5 mm) except for floor panels which have a maximum length of 3,000 mm
Joint junction	Special locking system, incorporated in the panel during the injection of the foam
Finish	Coated galvanised steel, white laquered RAL 9010, thickness 0.63 mm, with removable protective film as standard Other options are also available
Floor panel	Multiplex of 9 mm with phenolic, anti-slip layer as standard Other floor finishings are also available
Corner profiles	PVC profiles, PUR insulation with protective, removable film (curved corner profiles in PVC or aluminium are optional)
Insulation	Rigid PUR foam core, CFC free, density 40 kg/m ³ (± 3 kg/m ³)
Lambda value	0,0223 W/m.K – EN 12667 – after 9 weeks
Reaction to fire	Panels and doors B-s3, d0 according to NF EN 13501-1 Floors Cfl-s1 according to NF EN 13501-1



CLEANSafe 25 μ
RAL 9010 - White



CLEANSafe AISI 304-316
Sun brushed

CLEANSafe AISI 304 - Natural 2B
CLEANSafe AISI 304 - Line brushed 4N



CLEANSafe AISI 304
Design Linen

Panel range

The ISO Range allows for controlled environments at various temperatures, based on the requirements and type of application, as well as the type of ISO panel used (see table below for details).

Type of panel	Thickness of the panel	Weight	U value-thermal transmission	Range of temperatures*
ISO 60	60 mm	12.5 kg/m ²	0.372 W/m ² K	Ambient temperatures at -0 °C
ISO 80	80 mm	13.3 kg/m ²	0.279 W/m ² K	Ambient temperatures at -18 °C
ISO 100	100 mm	14.1 kg/m ²	0.223 W/m ² K	Ambient temperatures at -25 °C
ISO 140	140 mm	15.7 kg/m ²	0.159 W/m ² K	Negative temperatures up to -30 °C
ISO 180	180 mm	17.3 kg/m ²	0.123 W/m ² K	Negative temperatures up to -60 °C

* Depending on ambient temperature and local humidity conditions

Internal wall and ceiling panels

The internal wall and ceiling panels in the ISO range use a coated galvanised steel sheet with a CLEANSafe 25 finish (polyester 25 μ m), protected by a removable film.

Based on the specific project needs, a wide range of coatings and finishes are available:

- steel sheet with CLEANSafe 55, RAL 9010 white coating
- optional coatings:
 - Stainless steel sheet-CLEANSafe INOX 304 or 316 - sun brushed
 - Stainless steel sheet-CLEANSafe INOX 304 - natural 2B
 - Stainless steel sheet-CLEANSafe INOX 304 - line brushed 4N
 - Stainless steel sheet-CLEANSafe INOX 304 - design linen

For more information, please read our 'Coating Selector & Maintenance Guide' brochure, downloadable on our website www.isomasters.com



Note: the above door is installed with a fixed frame on IND panels

ISO RANGE

Doors

isomasters proposes a complete range of high quality door systems for coldstore facilities. The **isomasters** doors are manufactured according to the strictest industrial standards.

The door leafs are galvanised steel, pre-coated in CLEANsafe 25 white RAL 9010.

Available on request:

- Galvanised steel with CLEANsafe 55, PET-film 55 µm in white RAL 9010
- Stainless steel
CLEANsafe INOX AISI 304
or AISI 316

See the 'Coating & Maintenance Guide' on our website: www.isomasters.com

The ISO range offers the following doortypes:

- Swing door Type DE-DD, single or double
- Small doors Type PE-PD
- Hinged service door Type BE-BD, single or double
- Sliding cold room door Type EN
- Door options:
an extensive range of options is available. Please contact your sales representative for more information.



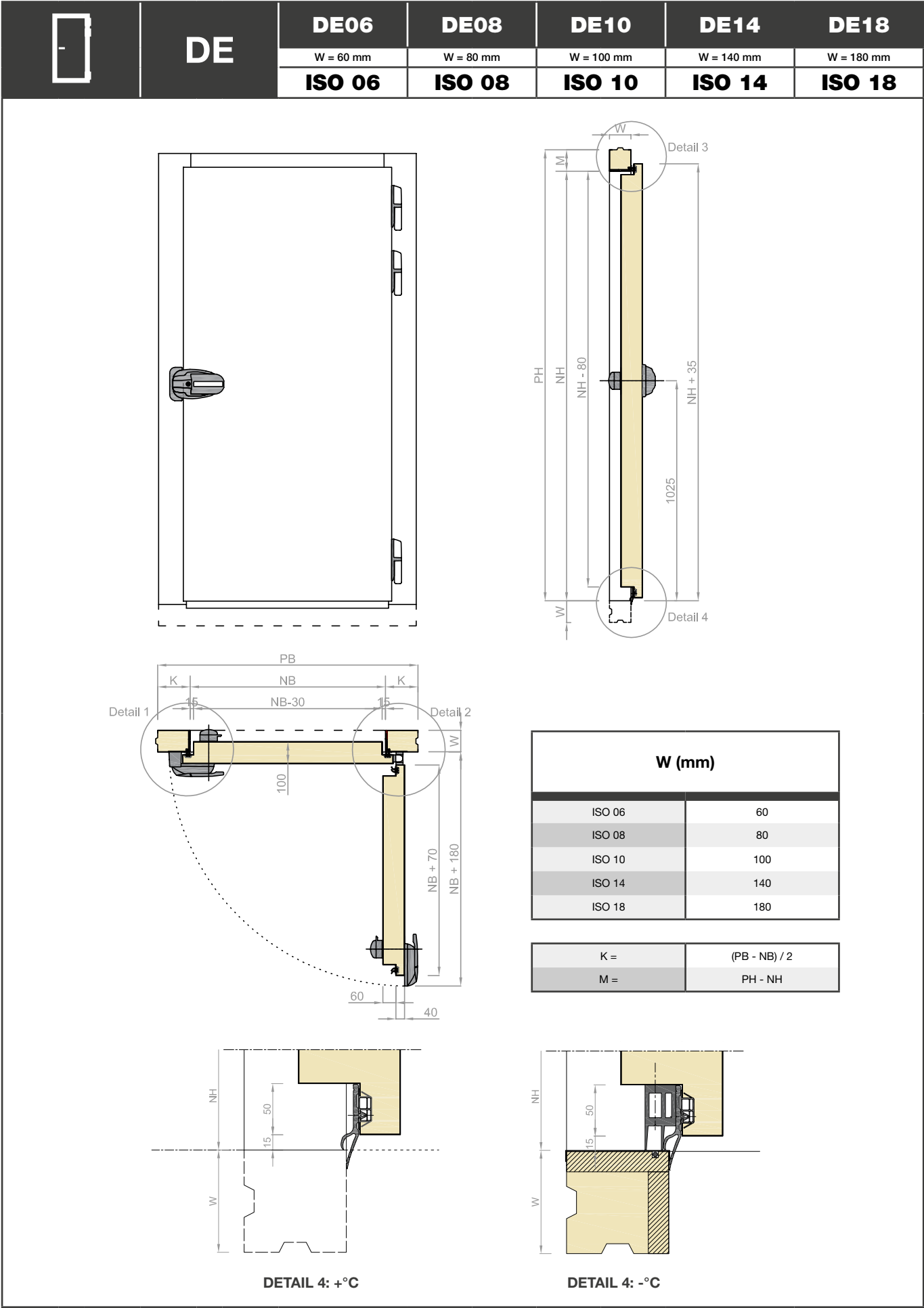

	PE PD	PE06	PE08	PE10	PE14	PE18
		W = 60 mm	W = 80 mm	W = 100 mm	W = 140 mm	W = 180 mm
		ISO 06	ISO 08	ISO 10	ISO 14	ISO 18

PE

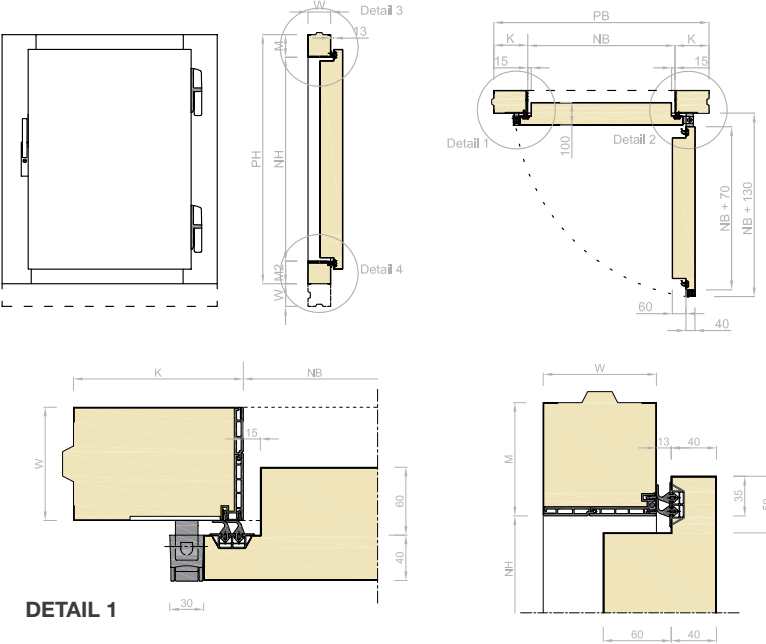

W (mm)	
ISO 06	60
ISO 08	80
ISO 10	100
ISO 14	140
ISO 18	180

K =	(PB - NB) / 2
M =	PH - NH + M2

PD

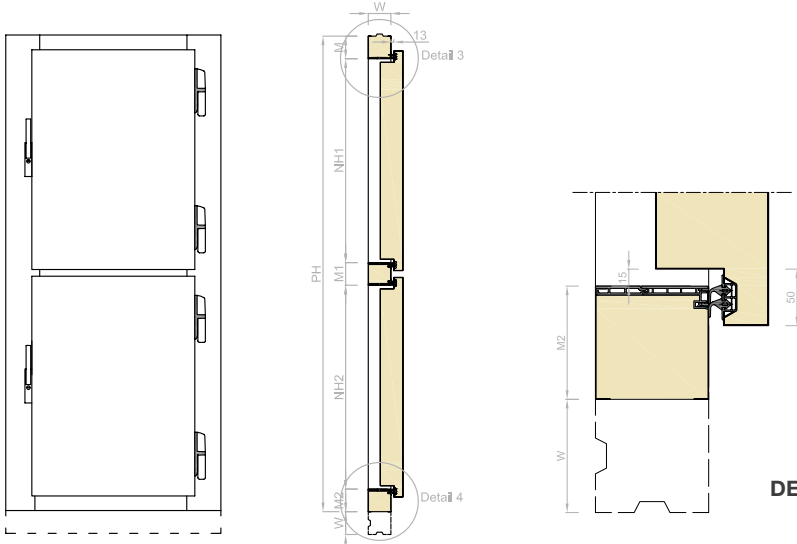

W (mm)	
ISO 06	60
ISO 08	80
ISO 10	100
ISO 14	140
ISO 18	180

K =	(PB - NB) / 2
-----	---------------

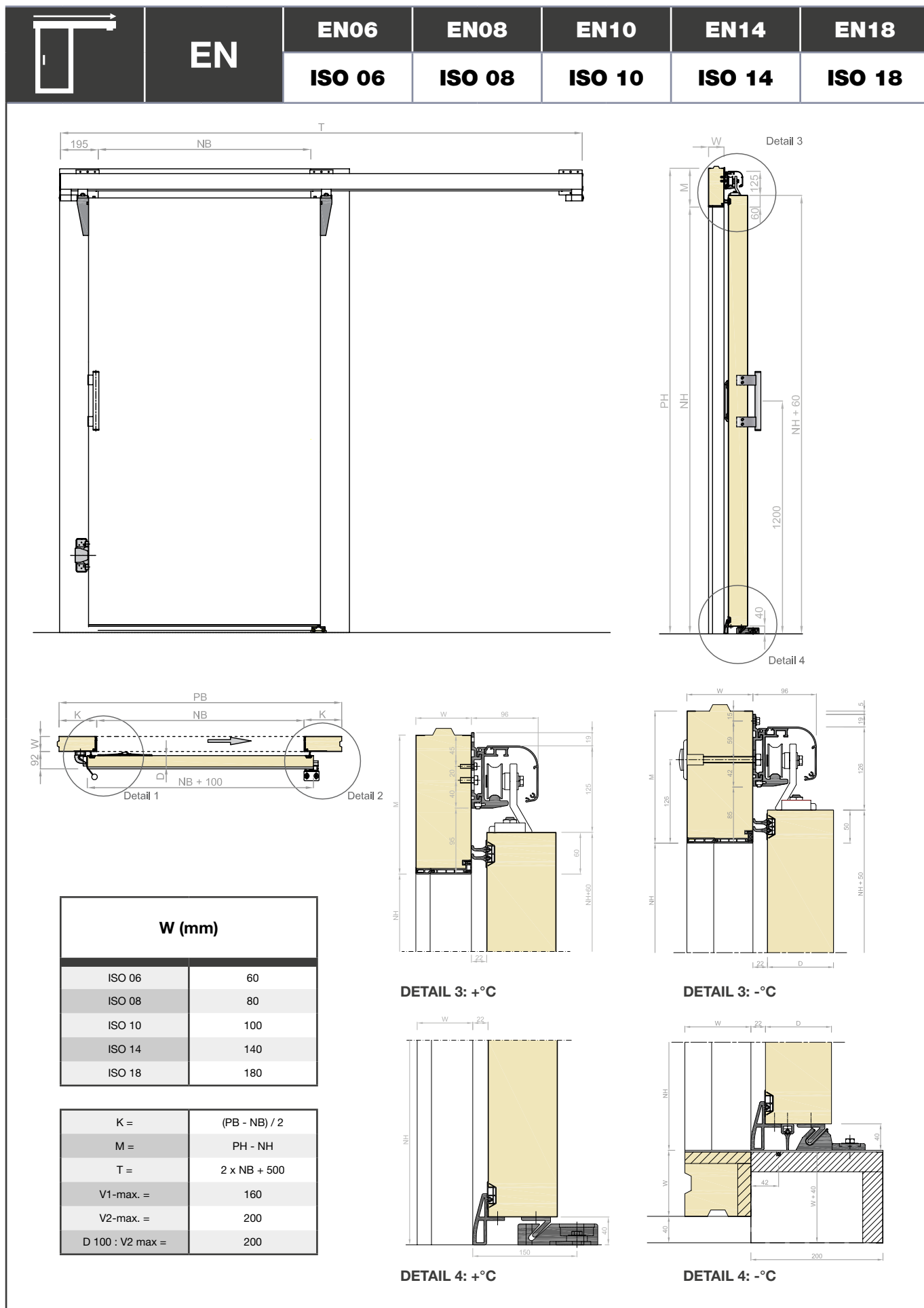



Note: the door handles indicated on the photo are optional.

ISO-RANGE

Floor solutions

The **isomasters** floor panels are in accordance with the strictest industrial norms.

Thanks to a large range of floor coatings, it is easy to find the appropriate option for your project needs.

Standard floor



Floor with PVC coating



Inox steel sheet 5WL with anti-slip R13



Floor support	Floor coating	Maximum load* for 4 rubber wheels
Sandwich panel Factory assembly	Standard wooden multiplex covered with phenolic, anti-slip layer, 9 mm thick	500 kg
	Grey PVC coated - steel sheet of 0.80 mm	250 kg
	Inox steel sheet (AISI 304) 5WL with anti-slip R13, 0.80 mm thick	500 kg
Site assembly: Sandwich panel with waterproof multiplex 9 mm, to be covered with:	Aluminium profiled sheet (skid proof), 2.5/4 mm thick	750 kg
	Aluminium profiled sheet (skid proof), 3.5/4 mm thick	1,000 kg
	Steel profiled sheet, 3 mm thick	1,200 kg
	Steel sheet with metal strip, 5/7 mm thick	1,500 kg

* Max. kg total weight = trolley/transpallet + goods all in.
Forklift trucks + electric pallettrucks/stackers are not allowed



Modular shelving systems ISOSTOCK

The modular shelving systems with moveable shelves allow for a practical and efficient storing system for food and other products in coldstore facilities.

Specifications:

- Anodised aluminium profiles
- Nutritional quality
- Corner joints across the entire depth allowing unobstructed access
- 4 adjustable shelves
- Configurations possible in 'L', 'U' and in 'cross' shape
- Simple and quick installation without tools
- Fit for temperature from -30 to +60°C
- Possibility to adjust the shelves at every 150 mm in order to reach the desired height
- Width of the shelving is 375 mm or 475 mm . Other configurations available on request
- Height of shelving = 1,700 mm



SUITABLE FOR GASTRONORM TRAYS

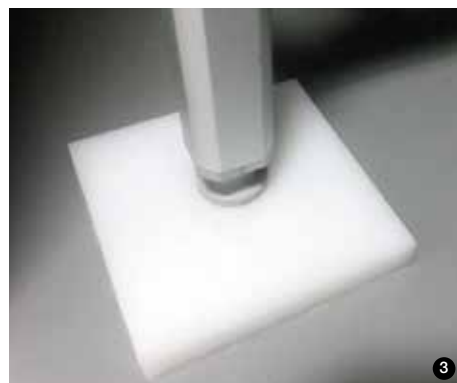

PROTECTION FOR MINIBOX/
COLDBOX STANDARD FLOOR



PERFORATED GRAY
SYNTHETIC GRIDS



ALUMINIUM GRIDS SUITABLE FOR
STORAGE OF WINEBOTTLES



MINIBOX

Product description

The MINIBOX is a coldroom solution for small businesses that wish to keep their produce refrigerated. This solution can easily be integrated in areas with limited space.

Thanks to its modular construction and simple installation, the MINIBOX can be easily integrated for private use as well as for smaller scale commercial applications, such as bakeries, supermarkets, pharmacies, restaurant services and restaurants.

Whether you are looking for a temperature controlled solution to conserve your best wines and food in a cold environment, or whether you wish to have a coldstore facility for private events, our MINIBOX is the most appropriate solution. It can also be used for SME's which need to manage their stocks with care, but do not have the necessary space to integrate a larger installation.

Technical specifications

Construction	Insulated PUR panels with modular dimensions
Module width	300 mm
Panel thickness	80 mm
Junction	Unique locking systems installed during the injection of the foam
Interior dimensions	min. 900 mm x 900 mm; max. 3,000 mm x 4,500 mm
Exterior height	2,100 mm = series 2100 2,400 mm = series 2400
Door	Hinged door with central door handle with key and internal safety release. Pressure relief valves and rafter profiles under floorpanel for negative temperatures are available on request
Usable dimensions	700 x 1,940 mmh on type MVL-with floor 700 x 2,020 mmh on type ZVL-without floor
Coating, internal walls & ceiling	Galvanised steel in pre-coated white CLEANsafe 25 RAL - 9010. Total thickness of 0.63 mm
Floor	Standard - Grey PVC coating on galvanised steel of 0.80 mm with a protective film Optional - Multiplex 9 mm with phenolic, anti-slip layer - Multiplex 9 mm & RVS 5WL stainless steel 0.60 mm - AISI 304-R13 - ventilation profiles under the floorpanels
Lambda value	0.0223 W/m.K - EN 12667 - after 9 weeks
Reaction to fire	Panel and doors B-s3, d0 according to NF EN 13501-1 Floors Cfl-s1 according to NF EN 13501-1

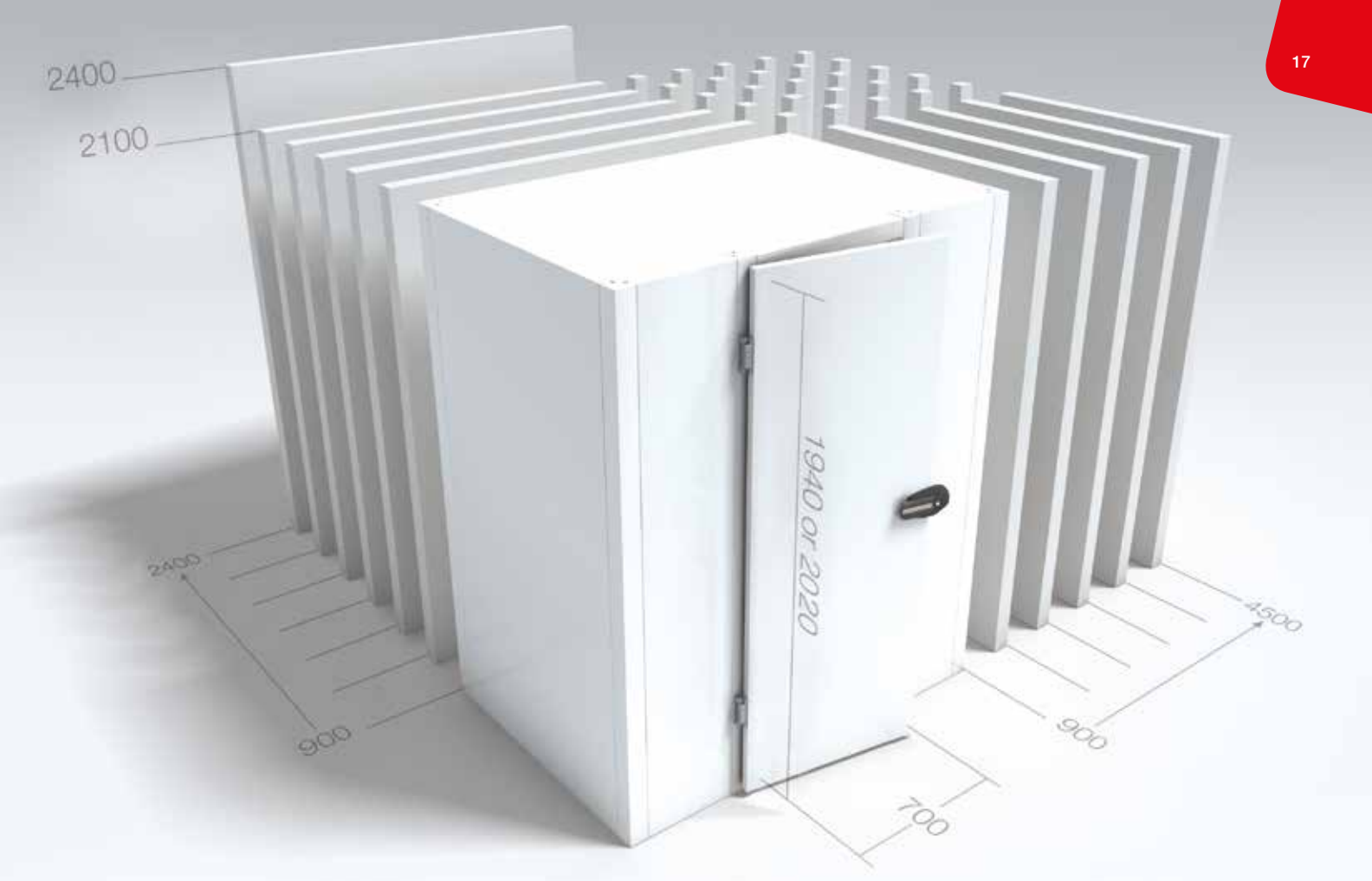

Installation

The MINIBOX is quick and easy to assemble and install. All packs are marked with descriptions of the product, individually packed and contain complete installation information.

The surface on which the floor panels are installed should be level and smooth. The panels are assembled with a unique locking system installed during the injection of the foam.

During the installation, the door of the MINIBOX can easily be reversed.

Please note that the electrical work must be carried out by qualified personnel.

Range of products

Depending on the use of the MINIBOX, **isomasters** offers two types:

- the MINIBOX ZVL-without floor, for positive temperatures
- the MINIBOX MVL-with floor, for temperatures from 0°C to -20°C - with rafter profiles under the floor panels (optional) and heating pressure relief ports (optional). It allows for the conservation and the storage of frozen goods.

The **isomasters** Modular Coldrooms are the ideal solution for coldstore and food processing facilities for kinds of all sector activities. The ISO range and MINIBOX are practical and efficient cold room solutions for storage facilities with the objective to store perishable goods.

MINIBOX advantages

- Practical and ergonomic solution
- Quick and easy installation
- Large choice of models and accessories





COLDBOX

Product description

The **isomasters** COLDBOX is a perfect all-in-one solution. It is a standard MINIBOX equipped with a corresponding cooling unit REFRIMATIC and an integrated ISOSTOCK rack arrangement in L or U shape. The range offers coolers from 1.20 x 1.20 m up to 2.10 x 2.40 m, or 3,000 l to 10,000 l.

The COLDBOX can be used for positive temperature applications (0° for type MVL with floor/ or +5°C for type ZVL without floor), as well as for negative temperature conditions (max -18°C for type MVL with floor).

The isothermal hinged door of the COLDBOX has a clear opening of 700 mm x 1,940 mmh (type MVL) or 2,020 mmh (type ZVL). For negative temperature applications the doorframe is equipped with a doorheating wire, the floor ventilated by PVC profiles, and a pressure relief valve supplied.

The compact cooling unit REFRIMATIC for indoor use is equipped with a airtight compressor, a capillary tube, an electronic thermostat and a low pressure switch.

The units are very easy to install, and can immediately be plugged in on 230V/50Hz. The units are ready to use following standard parameters.

REFRIMATIC COOLING UNIT						
UNIT - 230 V/50 Hz - mono		Temperature range	Captured power kW	Defrost capacity	Cooling cap. at +32°C Max. litres	
					ZVL	MVL
	ATN1060	0 °C	0.92 kW	1.10 kW	5,880	6,980
	ATN2100	0 °C	1.47 kW	1.90 kW	10,280	9,780
	ATK1170	-18 °C	1.35 kW	1.70 kW	-	5,240
	ATK2170	-18 °C	1.46 kW	1.70 kW	-	8,860

Each COLDBOX is delivered with an ISOSTOCK modular shelving system in anodised aluminium profiles. The racks can be set up in an L or U shape.

Height of the racks = 1,700 mm. With 4 x PE perforated synthetic grids of 373 mm depth, adjustable every 150 mm in height.

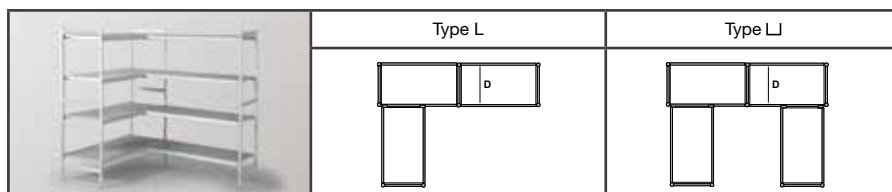



IND INDUSTRIAL SANDWICH PANELS



POWERED BY
QuadCore
TECHNOLOGY

IND



SEE ALSO OUR INDUSTRIAL APPLICATIONS



ISODOORS

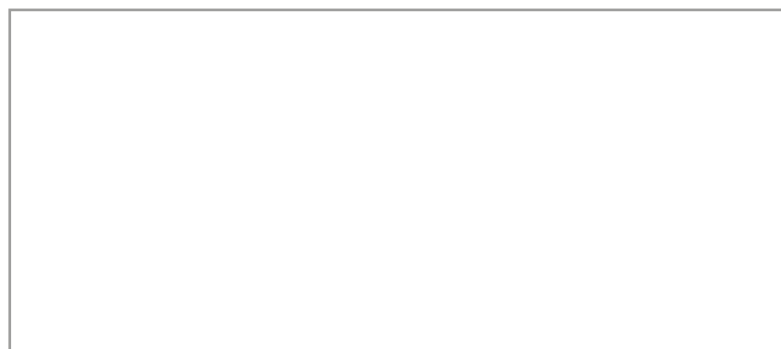

Care has been taken to ensure that the contents of this publication is accurate. However **isomasters** does not accept responsibility for errors or information that is found to be misleading. Suggestions for, or descriptions of, the end use or application of products or methods of working are for information only and **isomasters** accepts no liability in respect thereof. We reserve the right to modify specifications.

Ref. number: MOD-01.2018-EN

isomasters

isomasters nv

Pontstraat 80 • Waregem zone 11B • B-8791 Beveren-Leie
T +32 (0)56 71 04 94 • F +32 (0)56 70 32 87
info@isomasters.com
www.isomasters.com

PROUD DISTRIBUTOR OF
isocab
By Kingspan

ECOHOME
PANEL
By **isomasters**